

Select Desired Height

- 34" [863.6mm]
- 40" [1016.0mm]
- 46" [1168.4mm]
- 58" [1473.2mm]
- 70" [1778.0mm]

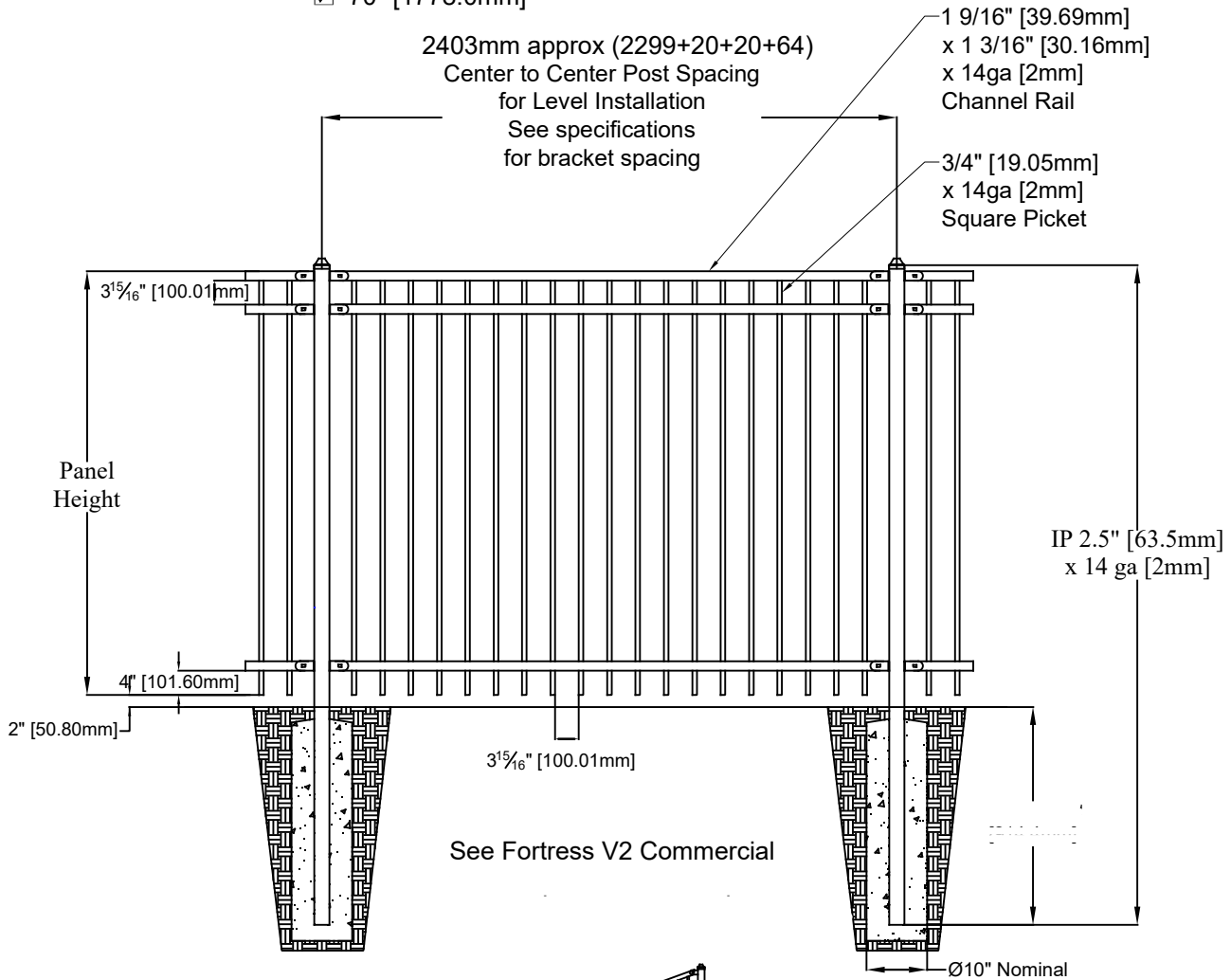

### Applicable Hardware

Brackets fixed to posts on site by Contractor with M5x25mm Self Tapping screws

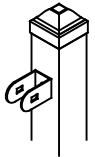

EX-106

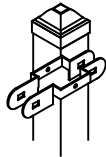

EXW-206

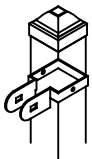

EXW-306

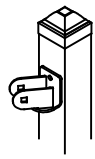

EXS-106

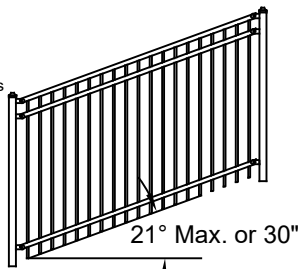

V2 RINGS-3D-COM  
for Level Installations  
(Optional)

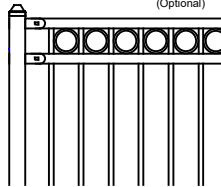

Architectural Grade Polyester Powder Coat

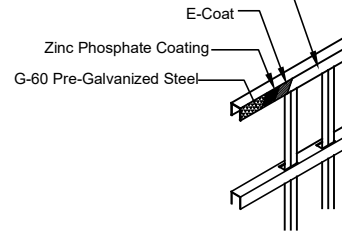

Style: Flat Top	Description: FT3-V2-COM-2298mm	
Height: 1.168m & 1.778m	Rev #:	Rev Date:
Panel Length: 2.299m	Scale: Do Not Scale	
Class: Commercial	Drawn By: JS	Date: 1/25/17